

POWERFLEX®

PART NUMBER

PFF12-201& PFF12-201-56

DESCRIPTION

FRONT ARM BUSH/FRONT WISHBONE BUSH

INSTALLATION GUIDE

Contents (parts per pack):

- 2 x Polyurethane Bushes
- 1 x PTFE/Silicone Grease
- 2 x Stainless Steel Sleeves
- 2 x Clear Anodised Mild Steel Outer Shells

Please read the complete fitting instructions and check package components before fitment. These fitting instructions are to be used as a guide and in conjunction with workshop manual.

It is recommended that:

- all work to be carried out by a licensed technician;
- all safety precautions adhered to;
- wheel alignment to be checked and adjusted as required after any suspension work.
- All fasteners must be tensioned to manufacturer's torque settings.



Fitting Instructions:

1. Remove the original rubber bush from the front arm.
2. Clean any dirt and corrosion from the bore of the arm and file off any sharp edges.
3. Press the clear anodised mild steel outer shell into the arm from the top side of the arm until the larger diameter of the shell is against the arm.
4. Press the polyurethane bush into the top of the outer shell with the smallest diameter entering the shell first.

Tip: it may be necessary to apply some washing up liquid to the outside of the bush and to angle the bush for ease of fitting.

5. Apply some of the supplied grease into the bore of the polyurethane bush and insert the stainless steel sleeve into the bush so that it sits flush.
6. Refit the front arm back to the vehicle and tension all hardware to manufacturers recommended torque settings.

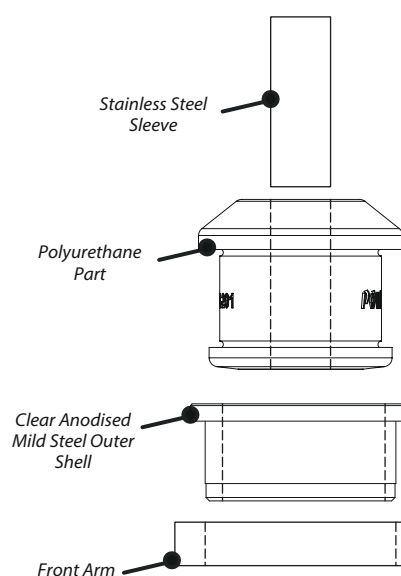
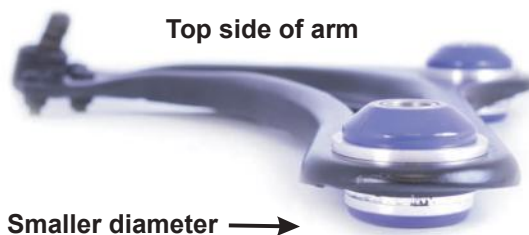

Figure 1