

POWERFLEX®

PART NUMBER

PFF5-402

DESCRIPTION

FRONT TRACK CONTROL ARM INNER BUSH

INSTALLATION GUIDE

Contents (parts per pack):

2 x Polyurethane Bushes 1 x PTFE/Silicone Grease
2 x Stainless Steel Washers 2 x Stainless Steel Sleeves

Please read the complete fitting instructions and check package components before fitment. These fitting instructions are to be used as a guide and in conjunction with workshop manual.

It is recommended that:

- all work to be carried out by a licensed technician;
- all safety precautions adhered to;
- wheel alignment to be checked and adjusted as required after any suspension work.
- All fasteners must be tensioned to manufacturer's torque settings.

Fitting Instructions:

1. Remove the original rubber bush and clean away any dirt and corrosion, remembering to also file away any sharp edges.
2. Press the Polyurethane Bush into the bore of the arm, until both lips sit on the outer surfaces of the arm securely.

Tip - Lubricate the bush with washing up liquid and press it into the bore at a slight angle to aid the insertion of the bush into the arm.

3. Apply some of the supplied grease to the outer surface of the Stainless Steel Sleeve and insert it into the bore of the Polyurethane Bush until it sits flush within the bore.

4. Place the Stainless Steel Washer onto the groove at the end of the Stainless Steel Sleeve so its sits onto it, and refit the arm into the void of the subframe where the arm was originally fitted, ensuring to take note of the positioning shown in Figure 2. Ensure to tension all hardware to manufacturers recommended torque settings.



FRONT OF CAR

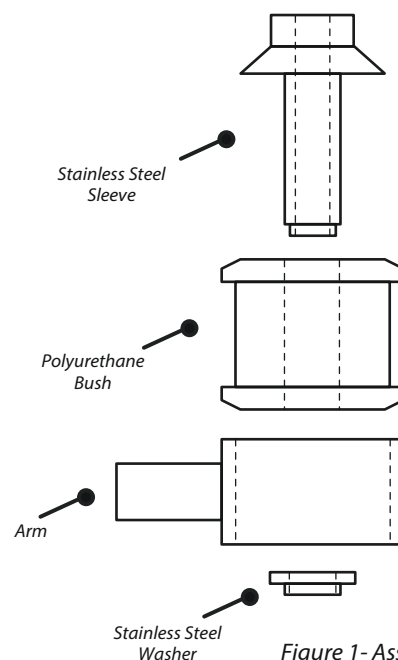

Figure 1- Assembly



FRONT OF CAR

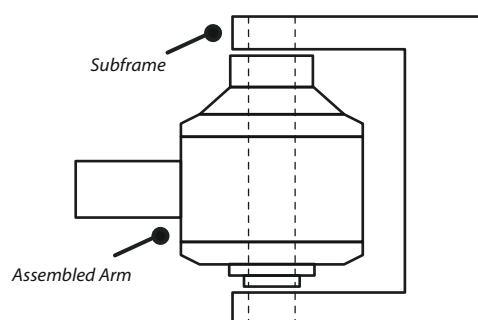

Figure 2 - Fitting the arm